



CIVIL GEOTECHNICAL SERVICES
ABN 26 474 013 724
PO Box 678 Croydon Vic 3136
Telephone: 9723 0744 Facsimile: 9723 0799

19th July 2023

Our Reference: 23265:NB1616

Winslow Constructors Pty Ltd
50 Barry Road
CAMPBELLFIELD VIC 3061

Dear Sirs/Madams,

**RE: LEVEL 1 EARTHWORKS INSPECTION AND TESTING
OFFICER CENTRAL – STAGE 6 (OFFICER)**

Please find attached our Report No's 23265/R001 to 23265/R006 which relate to the field density testing that was conducted within the filled allotments at the above subdivision. The level 1 inspections and associated field density testing was performed in March 2023.

The inspections and testing of the earthworks was undertaken in general accordance with the Level 1 requirements of AS 3798 - Guidelines on Earthworks for Commercial and Residential Developments.

The site inspection and testing was performed by experienced geotechnicians from this office. Any areas that were deemed unsatisfactory were reworked and retested under their supervision. The testing was performed to the relevant Australian Standards and the accompanying test reports carry NATA endorsement. The attached compaction results, which were located randomly throughout the fill profile, are considered to be representative of the bulk fill materials that were placed across the reported allotments by Winslow Constructors during the aforementioned period. The approximate locations of the field density tests can be seen on the attached plan (Figure 1).

We are of the view that the bulk fill materials that have been placed across the reported allotments by Winslow Constructors during the aforementioned period can be considered as having been placed in a controlled manner to a minimum density ratio of 95% (standard compactive effort).

Please contact the undersigned if you require any additional information.

Civil Geotechnical Services

A handwritten signature in blue ink, appearing to be 'Nick Brock', is written over a light blue circular stamp.

Nick Brock

FIGURE 1

- FILL GREATER THAN 200mm
- CUT GREATER THAN 200mm

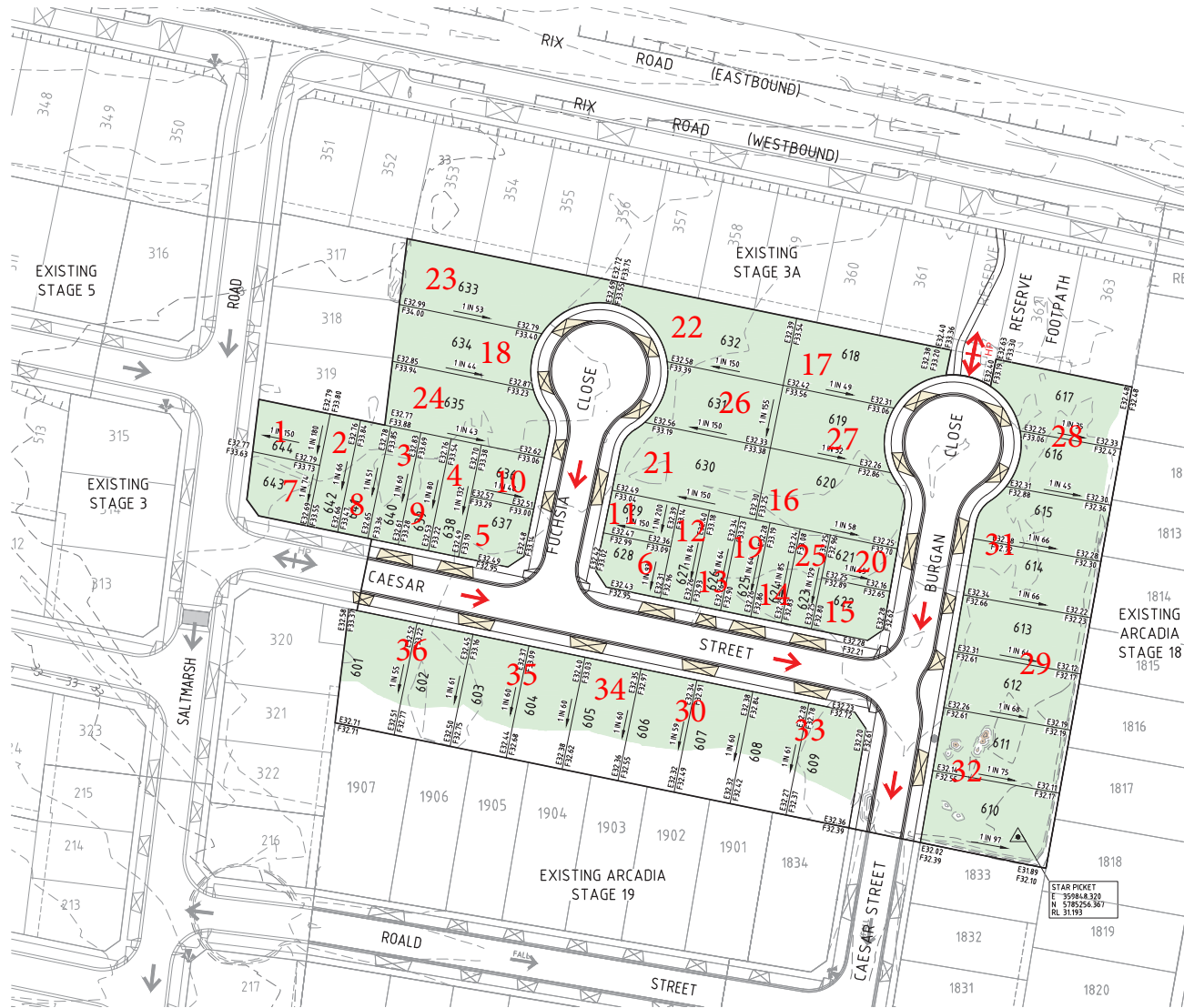

Approximate field density test location



WARNING
BEWARE OF UNDERGROUND/OVERHEAD SERVICES
THE LOCATION OF SERVICES ARE APPROXIMATE ONLY AND THEIR EXACT POSITION SHOULD BE PROVEN ON SITE. NO GUARANTEE IS GIVEN THAT ALL EXISTING SERVICES ARE SHOWN. SPECIAL CONSIDERATION SHOULD BE GIVEN TO CONSTRUCTION PROCEDURES UNDER OVERHEAD ELECTRICITY TRANSMISSION LINES.

File Name: 309134CR202_A11.dwg, User: b.wareham, PLOT DATE: 16/12/2022 4:10 PM, Sheet: 4 of 14, Sheets
 File Location: \\spire.com.au\barbara\309134CR202\309134CR202_A11.dwg, Job No: 309134CR202

Rev	Amendments	Approved	Date
0	ISSUED FOR CONSTRUCTION	B.W.	16/12/22

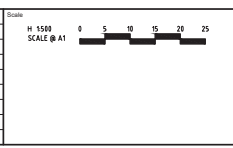

System Certified

© Spiire Australia Pty Ltd All Rights Reserved
This document is provided by Spiire Australia Pty Ltd solely for the benefit of and use by the client in accordance with the terms of the contract. Spiire Australia Pty Ltd does not warrant that it assumes any responsibility or liability whatsoever to any third party arising out of any use or reliance by third party on the content of this document.

16 BRIDGE STREET BENDIGO
VICTORIA 3550 AUSTRALIA T 61 3 5448 2500
spire.com.au ABN 55 050 029 635

Designed
S.SALHAN

Checked
B.IBBS - PE0007167

Authorised
B.WAREHAM

Date
14/11/22

OFFICER CENTRAL STAGE 6
ROAD AND DRAINAGE
ROAD LAYOUT PLANS - EARTHWORKS PLAN
CARDINIA SHIRE
YOURLAND

CONSTRUCTION 309134CR202



COMPACTION ASSESSMENT

Job No 23265
 Report No 23265/R001
 Date Issued 03/04/23

CIVIL GEOTECHNICAL SERVICES

6 - 8 Rose Avenue, Croydon 3136

Client	WINSLOW CONSTRUCTORS PTY LTD (CAMPBELLFIELD)	Tested by	SB
Project	OFFICER CENTRAL - STAGE 6	Date tested	21/03/23
Location	OFFICER	Checked by	JHF

Feature	EARTHWORKS	Layer thickness	200 mm	Time:	10:30
---------	------------	-----------------	--------	-------	-------

Test procedure AS 1289.2.1.1 & 5.8.1

Test No	1	2	3	4	5	6
Location	REFER TO FIGURE 1	REFER TO FIGURE 1	REFER TO FIGURE 1	REFER TO FIGURE 1	REFER TO FIGURE 1	REFER TO FIGURE 1
Approximate depth below FSL						
Measurement depth	mm	175	175	175	175	175
Field wet density	t/m ³	2.13	2.13	2.14	2.14	2.13
Field moisture content	%	19.0	18.6	18.9	19.1	19.2

Test procedure AS 1289.5.7.1

Test No	1	2	3	4	5	6
Compactive effort	Standard					
Oversize rock retained on sieve	mm	19.0	19.0	19.0	19.0	19.0
Percent of oversize material	wet	0	0	0	0	0
Peak Converted Wet Density	t/m ³	2.17	2.14	2.14	2.20	2.17
Adjusted Peak Converted Wet Density	t/m ³	-	-	-	-	-
Optimum Moisture Content	%	21.0	21.0	21.5	21.5	21.0

Moisture Variation From Optimum Moisture Content	2.0% dry	2.0% dry	2.5% dry	2.0% dry	2.0% dry	2.0% dry
--	----------	----------	----------	----------	----------	----------

density and moisture ratio results relate only to the soil to the depth of test and not to the full depth of the layer

Density Ratio (R _{HD})	%	98.5	100.0	100.0	97.5	98.5	99.0
-----------------------------------	---	------	-------	-------	------	------	------

Material description

No 1 - 6 Clay Fill

AVRLOT HILF V1.10 MAR 13



NATA Accredited Laboratory No 9909
 Accredited for compliance with
 ISO/IEC 17025 - Testing

Approved Signatory : Justin Fry



COMPACTION ASSESSMENT

Job No 23265
 Report No 23265/R002
 Date Issued 07/07/23

CIVIL GEOTECHNICAL SERVICES

6 - 8 Rose Avenue, Croydon 3136

Client	WINSLOW CONSTRUCTORS PTY LTD (CAMPBELLFIELD)	Tested by	SB
Project	OFFICER CENTRAL - STAGE 6	Date tested	22/03/23
Location	OFFICER	Checked by	JHF

Feature	EARTHWORKS	Layer thickness	200 mm	Time:	09:00
---------	------------	-----------------	--------	-------	-------

Test procedure AS 1289.2.1.1 & 5.8.1

Test No	7	8	9	10	11	12	
Location	REFER TO FIGURE 1	REFER TO FIGURE 1	REFER TO FIGURE 1	REFER TO FIGURE 1	REFER TO FIGURE 1	REFER TO FIGURE 1	
Approximate depth below FSL							
Measurement depth	mm	175	175	175	175	175	
Field wet density	t/m ³	1.94	1.95	2.20	2.18	2.15	2.12
Field moisture content	%	21.9	24.4	22.5	22.0	23.7	21.7

Test procedure AS 1289.5.7.1

Test No	7	8	9	10	11	12	
Compactive effort	Standard						
Oversize rock retained on sieve	mm	19.0	19.0	19.0	19.0	19.0	
Percent of oversize material	wet	0	0	0	0	0	
Peak Converted Wet Density	t/m ³	1.97	1.97	2.23	2.20	2.17	2.14
Adjusted Peak Converted Wet Density	t/m ³	-	-	-	-	-	
Optimum Moisture Content	%	24.0	27.0	25.0	24.5	26.0	24.5

Moisture Variation From Optimum Moisture Content	2.0% dry	2.0% dry	2.5% dry	2.0% dry	2.0% dry	2.5% dry
--	----------	----------	----------	----------	----------	----------

density and moisture ratio results relate only to the soil to the depth of test and not to the full depth of the layer

Density Ratio (R _{HD})	%	98.5	99.0	99.0	99.5	99.5	99.5
-----------------------------------	---	------	------	------	------	------	------

Material description

No 7 - 12 Clay Fill

AVRLOT HILF V1.10 MAR 13



NATA Accredited Laboratory No 9909
 Accredited for compliance with
 ISO/IEC 17025 - Testing

Approved Signatory : Justin Fry



COMPACTION ASSESSMENT

Job No 23265
 Report No 23265/R003
 Date Issued 07/07/23

CIVIL GEOTECHNICAL SERVICES

6 - 8 Rose Avenue, Croydon 3136

Client	WINSLOW CONSTRUCTORS PTY LTD (CAMPBELLFIELD)	Tested by	SB
Project	OFFICER CENTRAL - STAGE 6	Date tested	23/03/23
Location	OFFICER	Checked by	JHF

Feature	EARTHWORKS	Layer thickness	200 mm	Time: 13:30
---------	------------	-----------------	--------	-------------

Test procedure AS 1289.2.1.1 & 5.8.1

Test No	13	14	15	16	17	18
Location	REFER TO FIGURE 1	REFER TO FIGURE 1	REFER TO FIGURE 1	REFER TO FIGURE 1	REFER TO FIGURE 1	REFER TO FIGURE 1
Approximate depth below FSL						
Measurement depth	mm	175	175	175	175	175
Field wet density	t/m ³	2.04	2.03	2.02	2.02	2.01
Field moisture content	%	23.5	24.4	27.6	26.3	22.2

Test procedure AS 1289.5.7.1

Test No	13	14	15	16	17	18
Compactive effort	Standard					
Oversize rock retained on sieve	mm	19.0	19.0	19.0	19.0	19.0
Percent of oversize material	wet	0	0	0	0	0
Peak Converted Wet Density	t/m ³	2.05	2.05	2.02	2.02	2.02
Adjusted Peak Converted Wet Density	t/m ³	-	-	-	-	-
Optimum Moisture Content	%	26.0	26.5	30.0	29.0	24.5

Moisture Variation From Optimum Moisture Content	2.0% dry	2.0% dry	2.0% dry	2.5% dry	2.0% dry	2.5% dry
--	----------	----------	----------	----------	----------	----------

density and moisture ratio results relate only to the soil to the depth of test and not to the full depth of the layer

Density Ratio (R _{HD})	%	100.0	99.5	100.0	100.0	99.0	99.5
-----------------------------------	---	-------	------	-------	-------	------	------

Material description

No 13 - 18 Clay Fill

AVRLOT HILF V1.10 MAR 13



NATA Accredited Laboratory No 9909
 Accredited for compliance with
 ISO/IEC 17025 - Testing

Approved Signatory : Justin Fry



COMPACTION ASSESSMENT

Job No 23265
 Report No 23265/R004
 Date Issued 07/07/23

CIVIL GEOTECHNICAL SERVICES

6 - 8 Rose Avenue, Croydon 3136

Client	WINSLOW CONSTRUCTORS PTY LTD (CAMPBELLFIELD)	Tested by	SB
Project	OFFICER CENTRAL - STAGE 6	Date tested	24/03/23
Location	OFFICER	Checked by	JHF

Feature	EARTHWORKS	Layer thickness	200 mm	Time: 12:00
----------------	-------------------	------------------------	--------	--------------------

Test procedure AS 1289.2.1.1 & 5.8.1

Test No	19	20	21	22	23	24
Location	REFER TO FIGURE 1	REFER TO FIGURE 1	REFER TO FIGURE 1	REFER TO FIGURE 1	REFER TO FIGURE 1	REFER TO FIGURE 1
Approximate depth below FSL						
Measurement depth	mm	175	175	175	175	175
Field wet density	t/m ³	1.99	2.00	1.92	1.90	2.07
Field moisture content	%	23.9	20.2	20.5	22.6	21.4

Test procedure AS 1289.5.7.1

Test No	19	20	21	22	23	24
Compactive effort	Standard					
Oversize rock retained on sieve	mm	19.0	19.0	19.0	19.0	19.0
Percent of oversize material	wet	0	0	0	0	0
Peak Converted Wet Density	t/m ³	2.00	2.01	1.92	1.90	2.07
Adjusted Peak Converted Wet Density	t/m ³	-	-	-	-	-
Optimum Moisture Content	%	24.0	22.5	22.5	25.0	23.5

Moisture Variation From Optimum Moisture Content	0.0%	2.0% dry	2.0% dry	2.5% dry	2.0% dry	2.0% dry
--	------	-------------	-------------	-------------	-------------	-------------

density and moisture ratio results relate only to the soil to the depth of test and not to the full depth of the layer

Density Ratio (R _{HD})	%	99.5	99.5	100.0	100.0	100.0	99.0
-----------------------------------	---	------	------	-------	-------	-------	------

Material description

No 19 - 24 Clay Fill

AVRLOT HILF V1.10 MAR 13



NATA Accredited Laboratory No 9909
 Accredited for compliance with
 ISO/IEC 17025 - Testing

Approved Signatory : Justin Fry



COMPACTION ASSESSMENT

Job No 23265
 Report No 23265/R005
 Date Issued 07/07/23

CIVIL GEOTECHNICAL SERVICES

6 - 8 Rose Avenue, Croydon 3136

Client	WINSLOW CONSTRUCTORS PTY LTD (CAMPBELLFIELD)	Tested by	SB
Project	OFFICER CENTRAL - STAGE 6	Date tested	27/03/23
Location	OFFICER	Checked by	JHF

Feature	EARTHWORKS	Layer thickness	200 mm	Time: 14:00
---------	------------	-----------------	--------	-------------

Test procedure AS 1289.2.1.1 & 5.8.1

Test No	25	26	27	28	29	30
Location	REFER TO FIGURE 1	REFER TO FIGURE 1	REFER TO FIGURE 1	REFER TO FIGURE 1	REFER TO FIGURE 1	REFER TO FIGURE 1
Approximate depth below FSL						
Measurement depth	mm	175	175	175	175	175
Field wet density	t/m ³	2.03	2.04	2.03	2.05	2.03
Field moisture content	%	19.1	20.8	22.5	23.1	23.3

Test procedure AS 1289.5.7.1

Test No	25	26	27	28	29	30
Compactive effort	Standard					
Oversize rock retained on sieve	mm	19.0	19.0	19.0	19.0	19.0
Percent of oversize material	wet	0	0	0	0	0
Peak Converted Wet Density	t/m ³	2.04	2.04	2.02	2.07	2.04
Adjusted Peak Converted Wet Density	t/m ³	-	-	-	-	-
Optimum Moisture Content	%	21.0	23.0	25.0	23.0	26.0

Moisture Variation From Optimum Moisture Content	2.0% dry	2.0% dry	2.5% dry	0.0%	2.0% dry	2.0% dry
--	----------	----------	----------	------	----------	----------

density and moisture ratio results relate only to the soil to the depth of test and not to the full depth of the layer

Density Ratio (R _{HD})	%	100.0	100.0	100.5	99.0	99.5	98.5
-----------------------------------	---	-------	-------	-------	------	------	------

Material description

No 25 - 30 Clay Fill

AVRLOT HILF V1.10 MAR 13



NATA Accredited Laboratory No 9909
 Accredited for compliance with
 ISO/IEC 17025 - Testing

Approved Signatory : Justin Fry



COMPACTION ASSESSMENT

Job No 23265
 Report No 23265/R006
 Date Issued 05/07/23

CIVIL GEOTECHNICAL SERVICES

6 - 8 Rose Avenue, Croydon 3136

Client	WINSLOW CONSTRUCTORS PTY LTD (CAMPBELLFIELD)	Tested by	SB
Project	OFFICER CENTRAL - STAGE 6	Date tested	28/03/23
Location	OFFICER	Checked by	JHF

Feature	EARTHWORKS	Layer thickness	200 mm	Time: 11:00
---------	------------	-----------------	--------	-------------

Test procedure AS 1289.2.1.1 & 5.8.1

Test No	31	32	33	34	35	36
Location	REFER TO FIGURE 1	REFER TO FIGURE 1	REFER TO FIGURE 1	REFER TO FIGURE 1	REFER TO FIGURE 1	REFER TO FIGURE 1
Approximate depth below FSL						
Measurement depth	mm	175	175	175	175	175
Field wet density	t/m ³	2.03	1.99	2.04	1.98	2.03
Field moisture content	%	21.3	22.6	23.6	20.0	24.5

Test procedure AS 1289.5.7.1

Test No	31	32	33	34	35	36
Compactive effort	Standard					
Oversize rock retained on sieve	mm	19.0	19.0	19.0	19.0	19.0
Percent of oversize material	wet	0	0	0	0	0
Peak Converted Wet Density	t/m ³	2.10	2.00	2.04	2.01	2.08
Adjusted Peak Converted Wet Density	t/m ³	-	-	-	-	-
Optimum Moisture Content	%	21.0	25.0	26.0	20.0	27.0

Moisture Variation From Optimum Moisture Content	0.5% wet	2.5% dry	2.0% dry	0.0%	2.0% dry	0.0%
--	----------	----------	----------	------	----------	------

density and moisture ratio results relate only to the soil to the depth of test and not to the full depth of the layer

Density Ratio (R _{HD})	%	96.5	99.5	100.0	98.5	98.0	99.5
-----------------------------------	---	------	------	-------	------	------	------

Material description

No 31 - 36 Clay Fill

AVRLOT HILF V1.10 MAR 13



NATA Accredited Laboratory No 9909
 Accredited for compliance with
 ISO/IEC 17025 - Testing

Approved Signatory : Justin Fry